



PRODUCT SPECIFICATION

MOD SECURE SURFACE 1500x200



INTRODUCTION

The MOD Secure Surface 1500 x 200 has been tested and certified to comply with the requirements of the Department of Health Environmental Design Guide, Adult Medium Secure Services, for use in secure applications where care must be taken to ensure that vulnerable patients are at minimal risk of harm.

The MOD Secure Surface 1500 x 200 is manufactured with a robust 1.5mm steel housing and frame powder painted white, with a 6mm thick opal polycarbonate diffuser ensuring it can withstand attack from a wide range of implements without compromising the integrity of the luminaire or posing a risk to patients. When installed with anti pick mastic the MOD Secure Surface 1500 x 200 complies with ligature resistant requirements and is also rated to IK10 and IP40.

The MOD Secure Surface 1500 x 200 has been designed to ensure that alongside the critical safety requirements it is also able to provide a pleasant atmosphere for patient recovery with a wide range of optional lumen outputs, colour temperatures, dimming options, integral lithium emergency and white tunable options. We offer a range of wireless control systems providing localised grouping and control as well as comprehensive wireless solutions allowing both standard and emergency luminaires to be centrally monitored.

UK CA	CE	IP40	IK10	TM21: L90>60K HOURS / L80>90K HOURS	3 STEP MACADAM ELLIPSE
----------	----	------	------	-------------------------------------	------------------------

MOD SECURE SURFACE 1500X200 - APPLICATION

- Healthcare / Social Housing

MOD SECURE SURFACE 1500X200 - SPECIFICATION

CONSTRUCTION

- Housing: Compliant with the requirements of the Department of Health Environmental Design Guide, Adult Medium Secure Services.
- Finish: Polyester powder painted BS 00E55 matt white 60% gloss
- Diffuser: 6mm layered high transmission opal and clear polycarbonate TP(a) rated
- IK10

PERFORMANCE

- Part L2 compliant
- 3SDCM Three step Macadams ellipse
- TM21: L90>60K Hours / L80>90K Hours
- Up to 126 luminaire lumens per circuit Watt.

ENVIRONMENTAL

- Designed to allow simple replacement of components with commonly available tools in compliance with the Eco Design Directive, please see the installation leaflet for maintenance instructions.
- Powered by European branded drivers and emergency modules ensuring replacement parts are easily sourced.
- Every luminaire is labelled with a unique ID number allowing easy identification of spare parts for the lifetime of the product.
- Contains no single use plastics or polystyrene packaging.
- Supplied in plain card boxes with paper tape ensuring packaging is easily recycled.
- Designed to allow simple disassembly for end of life recycling.
- UK based manufacturing providing local support throughout the product lifetime and minimising transportation miles.

EMERGENCY

- Available with optional standard, self test and autotest integral emergency with lithium batteries for extended warranty and lifetime.
- Optional Reacta-Link wireless emergency for automated centralised reporting.
- Optional Reacta-Control wireless emergency for automated centralised reporting.
- Optional central battery changeover relay

CONTROL

- Optional compatibility with a range of dimming systems including DALI, DSI and Switch Dimming

- Optional White tunable
- Optional integral Reacta-Link for integration with Reacta-Link wireless installations
- Optional integral Reacta-Control for integration with Reacta-Control wireless installations

INSTALLATION

- Suitable for surface installation
- Suitable for external recessed installation

VARIATIONS

- Available with a wide range of colour temperatures and renderings
- Available in a range of lumen outputs
- Available with optional night light

MOD SECURE SURFACE 1500X200 - IMAGES



MOD Secure Surface 1500x200

MOD SECURE SURFACE 1500X200 - TECHNICAL

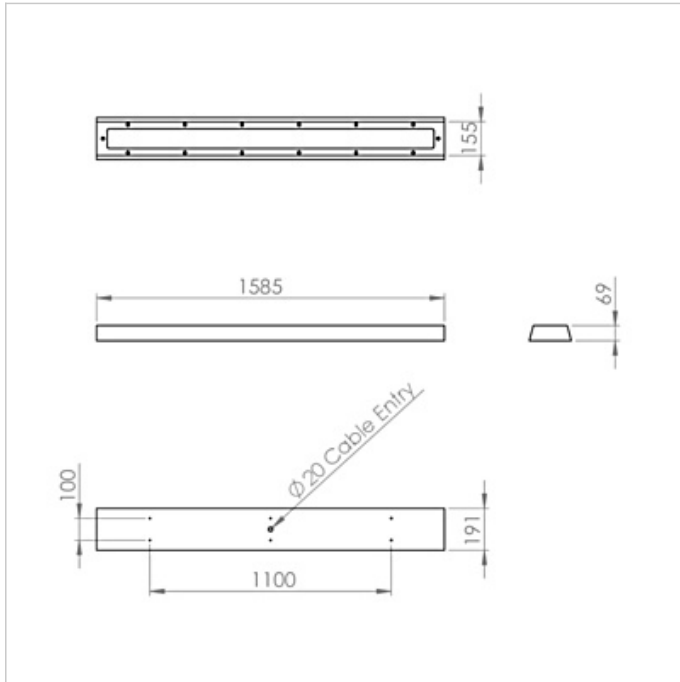

MOD Secure Surface 1500x200

MOD SECURE SURFACE 1500X200 - WARRANTY

At Dextra our commitment to service has been at the forefront throughout our history spanning more than forty years in the UK lighting market. Our service ethos extends beyond design and delivery, we believe supporting your installation throughout the warranty period is equally crucial, whilst the strength and longevity of Dextra Group provides peace of mind that our warranty will be supported throughout.

The Dextra range is supplied with a five year warranty commencing from the date of delivery. During the first three years defects will be repaired on site and the warranty will include both parts and labour. For the final two years drivers, emergency modules, wireless modules, sensors and LED circuits will be supplied free of charge to replace defective components, labour and other associated costs are not included.

Certain ranges and components are subject to exemptions:

- Lithium batteries are provided with a five year warranty. During the first three years defects will be repaired on site and the warranty will include both parts and labour. For the final two years replacement batteries will be supplied free of charge to replace defective components. Five year warranty became effective as of 03/02/25, Lithium emergency luminaires supplied prior to this date are supported with a three year on site warranty only. Labour and other associated costs are not included. Nickel Metal Hydride and Nickel Cadmium batteries are provided with a one year warranty for parts and labour.
- Emergency luminaires including AME LED, EXI LED, EXI2 LED, EXI Track, HBE LED, HBE2 LED, OAT2 LED, OEZ LED and Twinspot are supplied with a one year warranty for parts and labour. Lithium variants suffixed with the 5YR part code, the Autotest emergency with the LA3 part code and wireless variants with LA3RC or LSTR part codes are supplied with a five year warranty. For these extended warranty variants for the first three years defects will be repaired on site and the warranty will include both parts and labour. For the final two years replacement batteries will be supplied free of charge to replace defective components.
- Protec Micro, PTECF7 Fire Rated Downlights, Serenus and the Opus Sconce are provided with a five year replacement luminaire only warranty. Protec FR Fire Rated Downlights are provided with a 2 year replacement luminaire only warranty.
- Controls systems such as standalone sensors, switches, marshalling boxes and cabling are provided with a one year warranty for both parts and labour. DALI control systems are provided with a two year warranty for both parts and labour.
- LEDextra ranges are supplied with a three year parts or replacement luminaire only warranty with the exception of the IMPR RGBW, the Runway RGBW, the MOD RGBW, Tanek RGBW and the DexRing. These five ranges are supplied with our standard five year warranty during which defects within the first three years will be repaired on site and the warranty includes both parts and labour. For the final two years free of charge replacement components only will be supplied to rectify any failures but labour and other associated costs are not included.
- LEDEX ranges are supplied with a three year replacement luminaire only warranty.

- The Decorative Pendant ranges, Bebo, Dene, Nova, Fino and Stix are supplied with a 3 year replacement luminaire only warranty.

All warranties are subject to correct use of the product and will be invalidated by misuse, for example incorrect installation, unsuitable environmental conditions or incorrect maintenance. It is the duty of the customer to ensure that all the fault lies with the luminaire prior to requesting replacement parts or site repairs. In the event that no defect is found with the product our costs for attending site will be recharged to the customer and credit will not be issued against returned products. No consequential losses incurred resulting from any defect with our product will be reimbursed.

Given the nature of LED technology a small percentage of LEDs may fail during the lifetime of a luminaire, this does not cause a reduction in lumen output. As such LED luminaires are only deemed to be faulty for warranty purposes when in excess of ten percent of LEDs have failed in a single luminaire.

On site repair of products under warranty will be undertaken during normal working hours, 9am to 5pm Monday to Friday, and will require unrestricted access to luminaires. Where required Dextra will provide access equipment to carry out repairs at height, should luminaires have been installed in locations where reasonable provision for maintenance access has not been made we reserve the right to supply replacement product only. On site warranty repairs will only be undertaken on the mainland of the UK and Ireland, in all other locations replacement product only will be provided.

If you require any assistance with regards to our products please contact our Customer Services department on 01747 858100.

MOD SECURE SURFACE 1500X200 - ORDER CODES

LUMINAIRE CODES

Code	Description	Power	Llm/W
MODSECS 153 L35	MOD Secure Surface, 1585x191, 2,595llm, Colour 84	21.7W	119
MODSECS 153 L45	MOD Secure Surface, 1585x191, 3,375llm, Colour 84	26.7W	126
MODSECS 153 L54	MOD Secure Surface, 1585x191, 4,050llm, Colour 84	32.8W	123
MODSECS 153 L63	MOD Secure Surface, 1585x191, 4,725llm, Colour 84	38.6W	122
MODSECS 153 L96	MOD Secure Surface, 1585x191, 7,200llm, Colour 84	60.6W	118

DIMMING

Code	Description
A	DALI Digital Addressable Lighting Interface
S	Switch Dimming
D	DSI Digital Dimming
H	HFR Analogue 1-10v
C	Bi-Level Dimming For Standalone Switched Sensor
WT	White Tunable (Lumen Outputs Vary from Standard)

[Please click here for full details on our white tunable offer.](#)

CONTROL

Code	Description
RLI	Reacta-Link, Wireless Enabled Luminaire
RC	Reacta-Control, Wireless Enabled Luminaire

EMERGENCY

Code	Description
LE3	Lithium Standard Emergency 3 Hour
LS3	Lithium Selftest Emergency 3 Hour
LA3	Lithium Autotest Emergency 3 Hour
LSTR	Lithium Reacta-Link Emergency 3 Hour
LA3RC	Lithium Reacta-Control Emergency 3 Hour
CB	Central Battery, Please Specify 110V or 230V when Ordering

MISCELLANEOUS

Code	Description
C**	Select Colour Temperature and Rendering; C827, C83, C84, C85, C865, C93, C94
TRS INSTALL KIT	Tamper Resistant Compatible Screwdriver Heads
LSF	Low Smoke Zero Halogen
NL	Night Light

MOD Secure Surface Installation

220-240V / 50-60Hz

IP40

IK10

Terminal Labelling:

Power

L1

E

N

Emergency

L2

DA/AT3

DA/AT3

Dimming

-D1/DA

+D2/DA

L3

Switched Live
Earth
Neutral

Unswitched Live
DALI Autotest
DALI Autotest

Analogue/DSI/DALI
Analogue/DSI/DALI
Switch Dim / Corridor
Function



WARNING: Luminaire must be earthed. Risk of electric shock from LED boards if operated with cover removed. Installation / operation outside of luminaires intended scope invalidates warranty. Suitable only for domestic / light industrial / industrial applications within the scope of EN55015. Tested to compliance with BSEN 60598: specification for general requirements and tests. Must be installed by a suitably qualified person in accordance with all relevant legislation. Ambient operating temperature of 0°C to 25°C. If maximum operating temperature is exceeded luminaire will automatically dim / switch off. Terminal blocks are rated to 16A unless stated otherwise. The light source contained in this luminaire shall only be replaced by the manufacturer or his service agent or a similar qualified person.

LUMINAIRES WITH EMERGENCY PACK: When supply is isolated battery output terminals may be live if battery is connected. Isolate mains and battery before servicing. Emergency luminaires require unswitched live connection taken from same phase as switched supply. When unswitched supply is connected status indicator illuminates green, when unswitched supply is disconnected indicator extinguishes and luminaire operates in emergency mode. 24 hour charge period required before undertaking full discharge test. Emergency test sheets provided should be used to record all emergency tests. Batteries should be replaced when 3 hour duration is not met. Excessive switching of permanent live may result in premature battery failure. Battery electrolyte can be harmful to eyes / open wounds, do not puncture, if electrolyte touches skin / eyes flush with water. Do not incinerate batteries.

1.

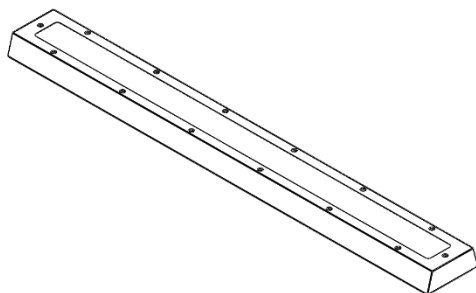

The fitting will come as a complete fitting, you will need to remove the front frame in order to install it onto an appropriate surface.

2.

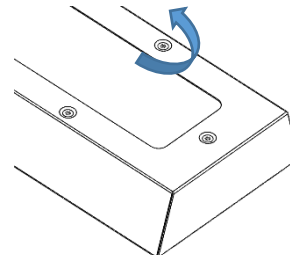

Undo the security fastener screws to release the front frame.

3.

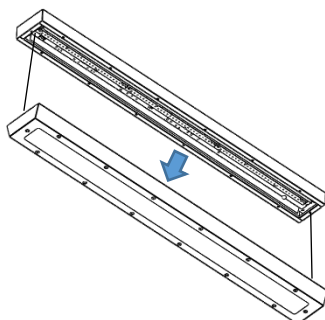

Remove the front frame and diffusers from the main body of the fitting. Allow the frame to hang from tether wires.

4.

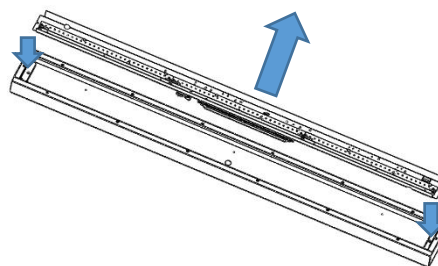

Unscrew the gear tray fixings at each end then remove the tray from the housing.

5.

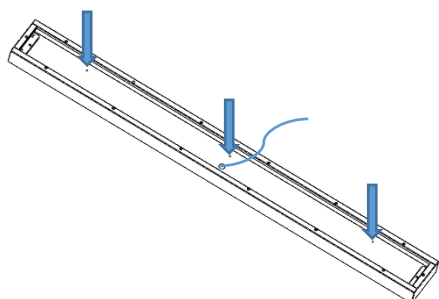

Feed the power cable through the central grommet hole. Then screw the housing to the wall using the 6 fixing points on the base of the housing.

6.

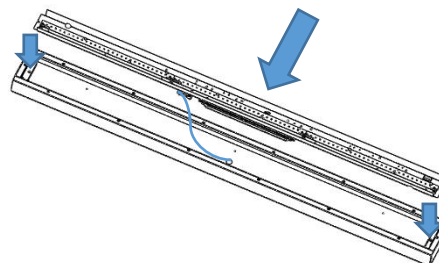

Wire the power cable into the chock block on the back of the gear tray. Then secure the gear tray back in to the housing using the fixings at each end.

MOD Secure Surface Installation

7.

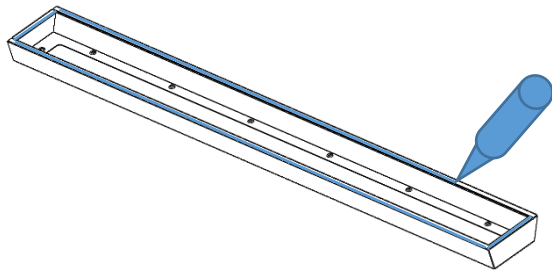

Before re attaching the frame, run a bead of **Anti-Pick Mastic** around the back face of the frame.

8.

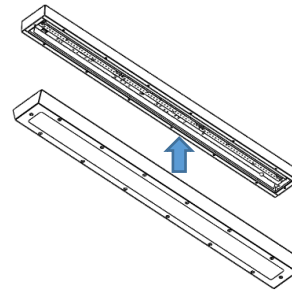

Offer up the front frame and diffusers to the main body of the fitting.

9.

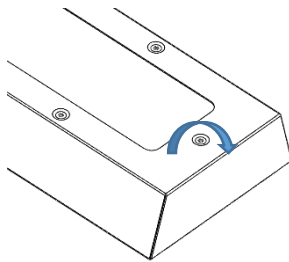

Tighten the security fastener screws to secure the front frame to the housing.

10.

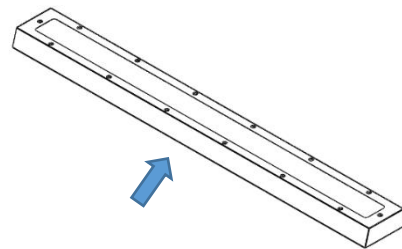

Wipe clean any excess mastic around the edge of the fitting.

Installation is now complete.

Maintenance

① Disconnect luminaire before undertaking any maintenance or cleaning.

② Cleaning should be undertaken on external parts of the luminaire only using a slightly damp lint free cloth.

③ Undo security fastener screws to access fitting using a torx pin.

④ To access gear tray remove screws on each end of tray.

⑤ Use a pan pozi screwdriver when removing components.

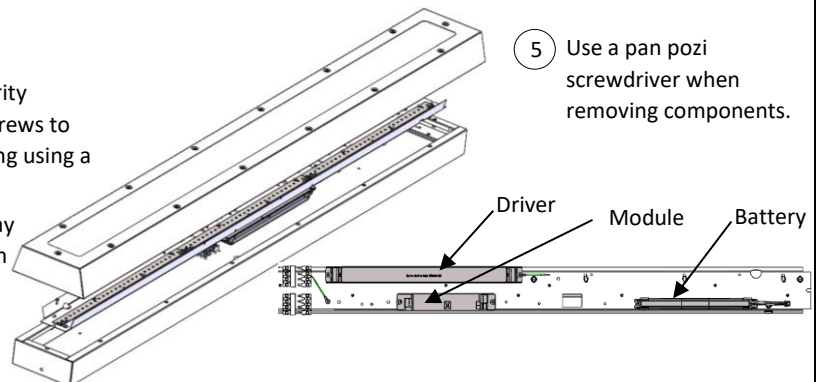

⑥ Please contact Dextra for assistance with spare component supply.