

AME2 M3/NM3 LE3/LS3 Installation Leaflet

Voltage: 220-240V / 50-60Hz
 LED Power: 4.5W (1W for NM3)
 Output: 460 lm (160 lm for NM3)
 Battery: Li-FeP04 18650 3.2V 1500mAh
 Operating Temperature: 0°C - 40°C

WARNING - THIS LUMINAIRE MUST BE EARTHED

This luminaire has been tested and is manufactured to comply with BS EN 60598 : specification for general requirements and tests. It should be installed by a suitably qualified person in accordance with IEE.

CAUTION: there is a potential risk of electric shock from the LED boards when the product is operational with the cover removed.

NOTE: INSTALLATION AND OPERATION OF THE LUMINAIRE BEYOND ITS SCOPE OF SUPPLY WILL INVALIDATE THE WARRANTY.



IP65

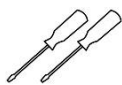

BEFORE installation, the electrical supply and battery pack **MUST** be disconnected.

1.

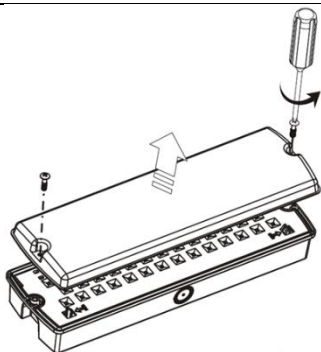

Remove the diffuser by loosening the two screws.

2.

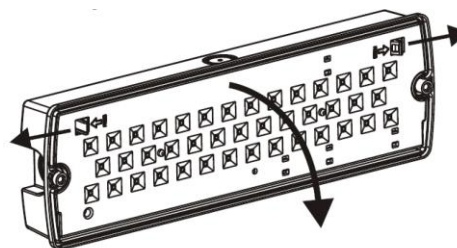

Release the tray by pushing the tabs outwards. Pull the tray down, away from the body.

3.

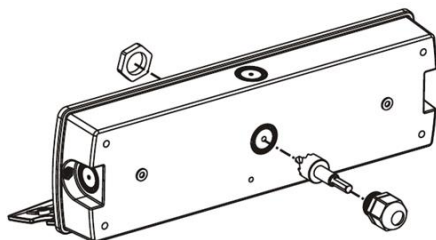

Drill out the cable entry point on the rear of the housing. Ensure a suitable cable gland is used in order to maintain the IP65 rating.

4.

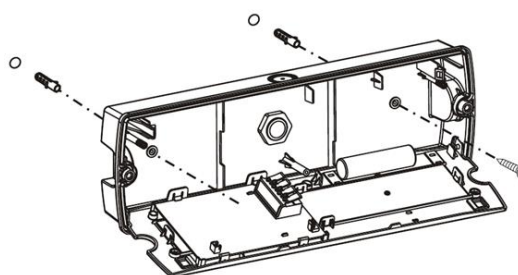

Drill through the two fixing points on the back face. Ensure the fixing points are adequately sealed in order to maintain the IP65 rating. Secure the luminaire with two screws.

5.

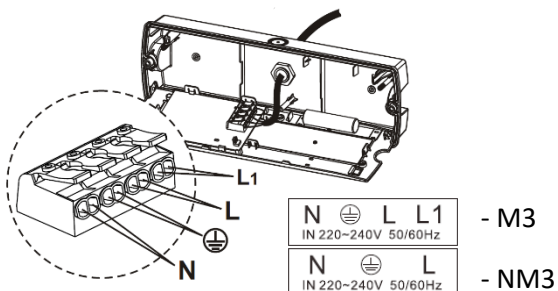

Pass the cable through the cable gland, and wire directly into the terminal block. Proceed to connect the battery.

6.

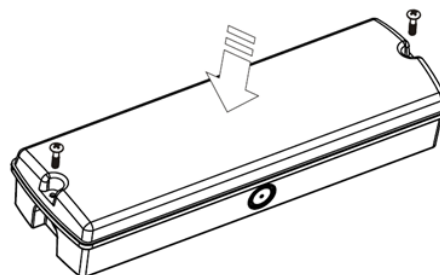

Refit the diffuser to the body, and secure in place using the two screws.

7.

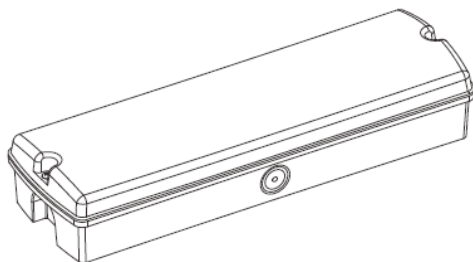

Reconnect the power supply and check that the green LED indicator is illuminated. This green indicator confirms the battery is charging.

LS3 only:

Any faults with the luminaire will be displayed by a flashing red indicator.

Normal operation - Green indicator

Battery failure - Red indicator, **once every 3 seconds**

Lighting source failure - Red indicator, **twice every 3 seconds**

Less than rated duration time - Red indicator, **three times every 3 seconds**

8.

Self-Test (LS3 only):

Every month, the luminaire will undergo an automatic test which lasts for 10 minutes. An annual duration test will also occur for a total of 3 hours.

The luminaire will return to normal operation once the test has finished.

During testing, the battery is not charging and the red LED indicator will flash continuously.

9.

Do **NOT** cover the luminaire in any way and provide sufficient ventilation.

Installation is now complete.

EMERGENCY LIGHTING TEST RECORD CARD											
LOCATION....		Date Installed...				Installed by...					
TEST	MONTH	YEAR 1		YEAR 2		YEAR 3		YEAR 4		YEAR 5	
		Signed	Date	Signed	Date	Signed	Date	Signed	Date	Signed	Date
1	FUNCT										
2	FUNCT										
3	FUNCT										
4	FUNCT										
5	FUNCT										
6	FUNCT										
7	FUNCT										
8	FUNCT										
9	FUNCT										
10	FUNCT										
11	FUNCT										
12	3HOUR										