

Runway Suspended / Surface Standalone Installation

220-240V / 50-60Hz
IP20



Terminal Labelling:

| | |
|------------------|--------------------------------|
| Power | |
| L1 | Switched Live |
| E | Earth |
| N | Neutral |
| Emergency | |
| L2 | Unswitched Live |
| DA/AT3 | DALI Autotest |
| DA/AT3 | DALI Autotest |
| Dimming | |
| -/D1/DA | Analogue/DSI/DALI |
| +/D2/DA | Analogue/DSI/DALI |
| L3 | Switch Dim / Corridor Function |



WARNING: Luminaire must be earthed. Risk of electric shock from LED boards if operated with cover removed. Installation / operation outside of luminaires intended scope invalidates warranty. Suitable only for domestic / light industrial / industrial applications within the scope of EN55015. Tested to compliance with BSEN 60598: specification for general requirements and tests. Must be installed by a suitably qualified person in accordance with all relevant legislation. Ambient operating temperature of 0°C to 25°C. If maximum operating temperature is exceeded luminaire will automatically dim / switch off. Terminal blocks are rated to 16A unless stated otherwise. The light source contained in this luminaire shall only be replaced by the manufacturer or his service agent or a similar qualified person. **LUMINAIRES WITH EMERGENCY PACK:** When supply is isolated battery output terminals may be live if battery is connected. Isolate mains and battery before servicing. Emergency luminaires require unswitched live connection taken from same phase as switched supply. When unswitched supply is connected status indicator illuminates green, when unswitched supply is disconnected indicator extinguishes and luminaire operates in emergency mode. 24 hour charge period required before undertaking full discharge test. Emergency test sheets provided should be used to record all emergency tests. Batteries should be replaced when 3 hour duration is not met. Excessive switching of permanent live may result in premature battery failure. Battery electrolyte can be harmful to eyes / open wounds, do not puncture, if electrolyte touches skin / eyes flush with water. Do not incinerate batteries.

1a. 2948mm Standalone (suspended)

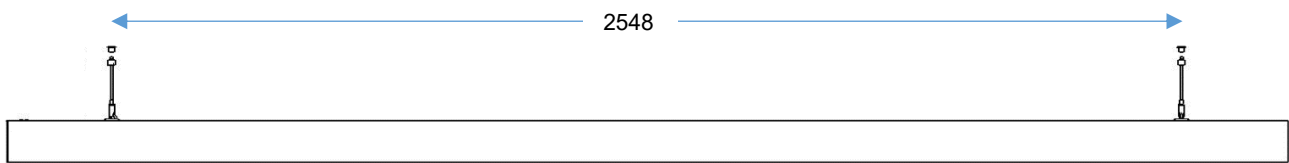

1b. 1474mm Standalone (suspended)

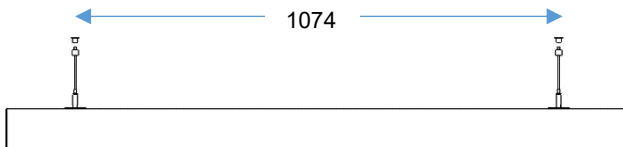

2.

Attach the suspension wire the spring brackets ready to be attached to the trunking.

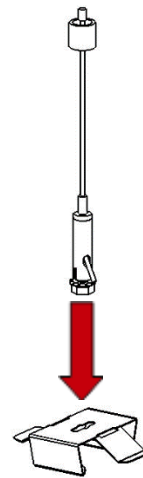

3.

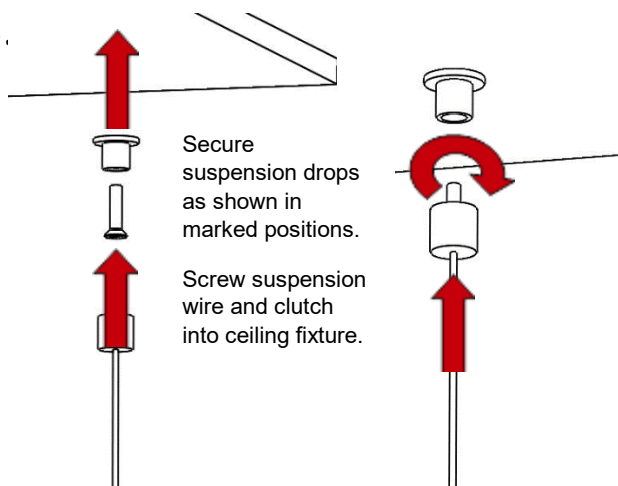

4.

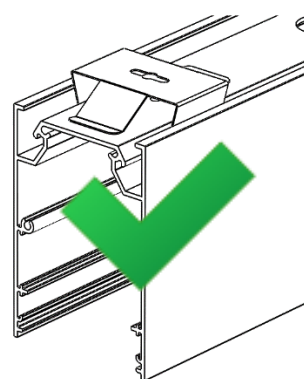

Correct Orientation

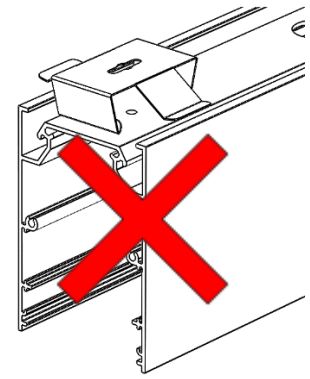

Wrong Orientation

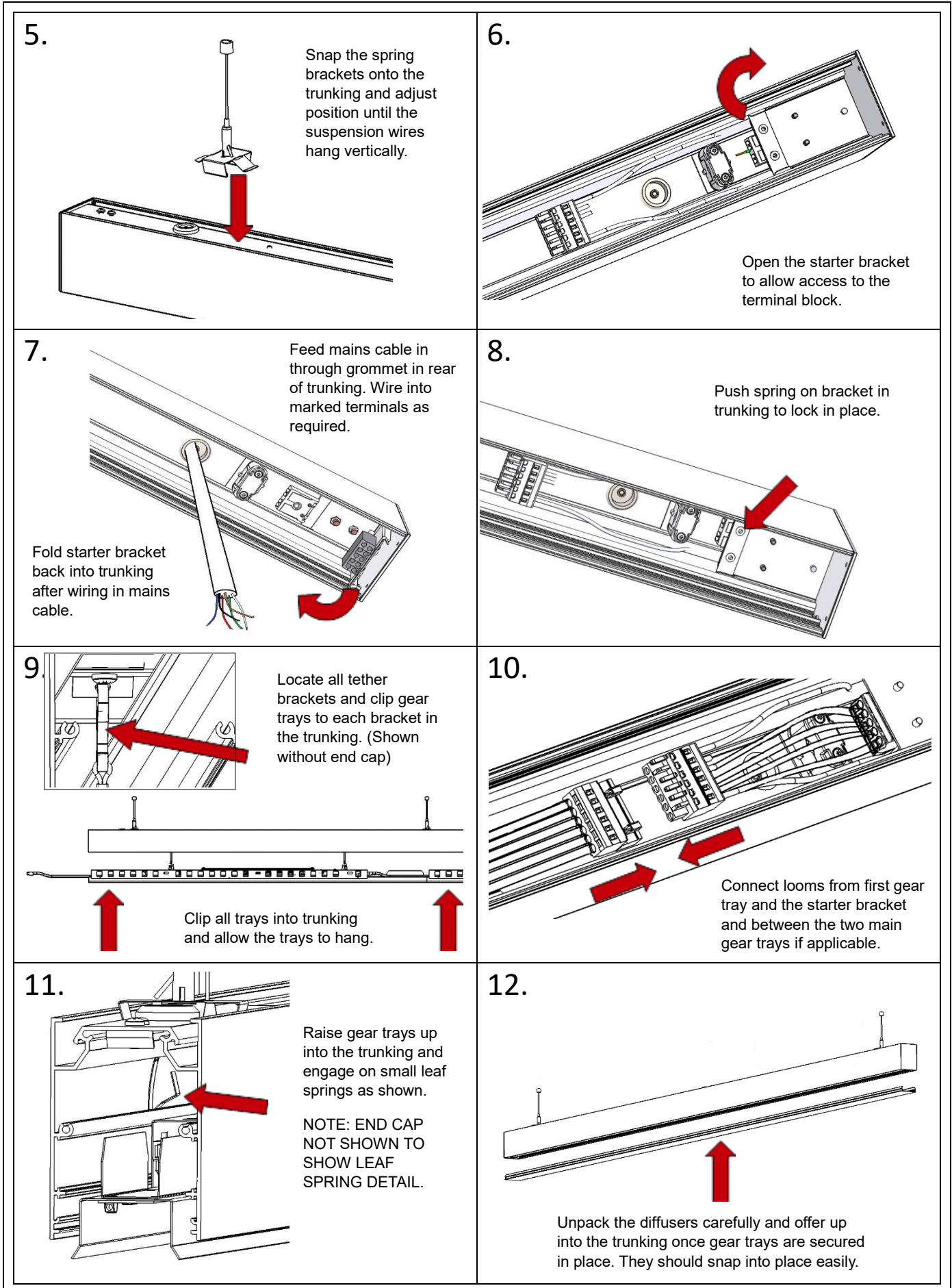

| | | |
|---|--|--|
| <p>1. Standalone (surface)</p> | | |
| <p>2.</p> <p>Secure surface mount brackets to ceiling using suitable screws. Ensure they are positioned correctly.</p> | <p>3.</p> <p>Once spring brackets are attached to ceiling, snap the trunking onto them ensuring they're secure.</p> | |
| <p>4.</p> <p>Open the starter bracket to allow access to the terminal block.</p> | <p>5.</p> <p>Feed mains cable in through grommet in rear of trunking. Wire into marked terminals as required.</p> <p>Fold starter bracket back into trunking after wiring in mains cable.</p> | |
| <p>6.</p> <p>Push spring on bracket in trunking to lock in place.</p> | <p>7.</p> <p>Locate all tether brackets and clip gear trays to each bracket in the trunking. (Shown without end cap)</p> <p>Clip all trays into trunking and allow the trays to hang.</p> | |

8.

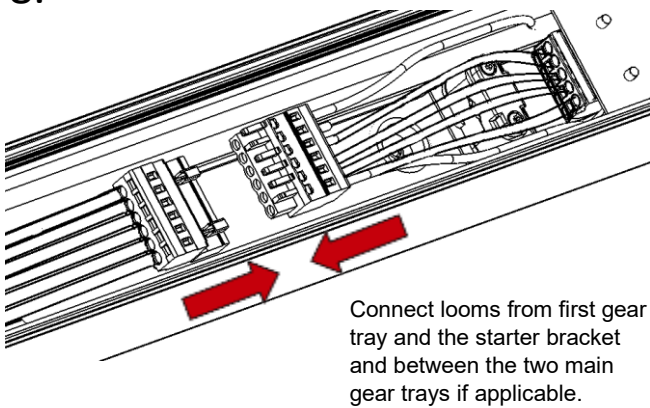

Connect looms from first gear tray and the starter bracket and between the two main gear trays if applicable.

9.

Raise gear trays up into the trunking and engage on small leaf springs.

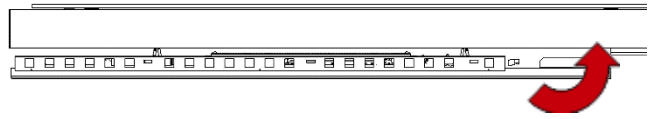

10.

Engage on small leaf springs as shown.

NOTE: END CAP NOT SHOWN TO SHOW LEAF SPRING DETAIL.

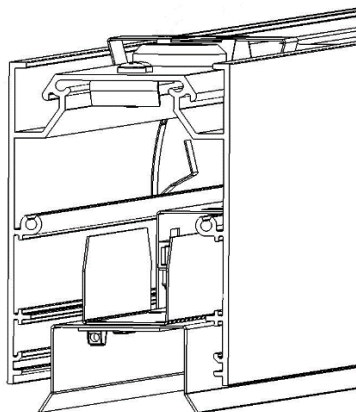

11.

Unpack the diffusers carefully and offer up into the trunking once gear trays are secured in place. They should snap into place easily.

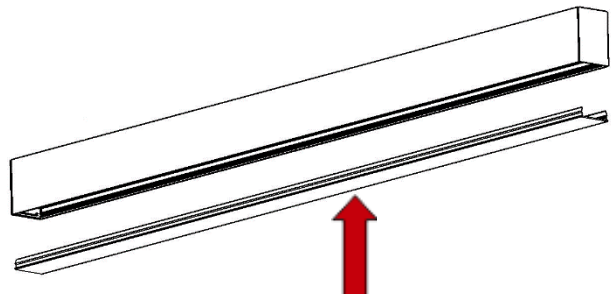

12.

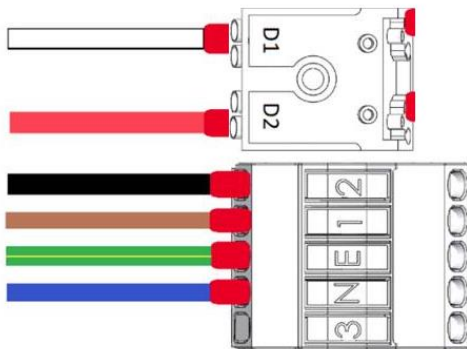

Maintenance

- 1 Disconnect luminaire before undertaken any maintenance or cleaning.
- 2 Cleaning should be undertaken on external parts of the luminaire only using a slightly damp lint free cloth.
- 3 Use a flat headed screwdriver to remove diffuser.
- 4 Remove gear tray from housing.
- 5 Remove plastic rivets to separate the two gear trays.
- 6 Use a pan pozi screwdriver to remove components.
- 7 Please contact Dextra for assistance with spare component supply.

